

# THERMOLEC/LAARS DUAL ENERGY SYSTEM CONNECTIONS

THERMOSTAT + VALVE + MC206  
AND CIRCULATING PUMP

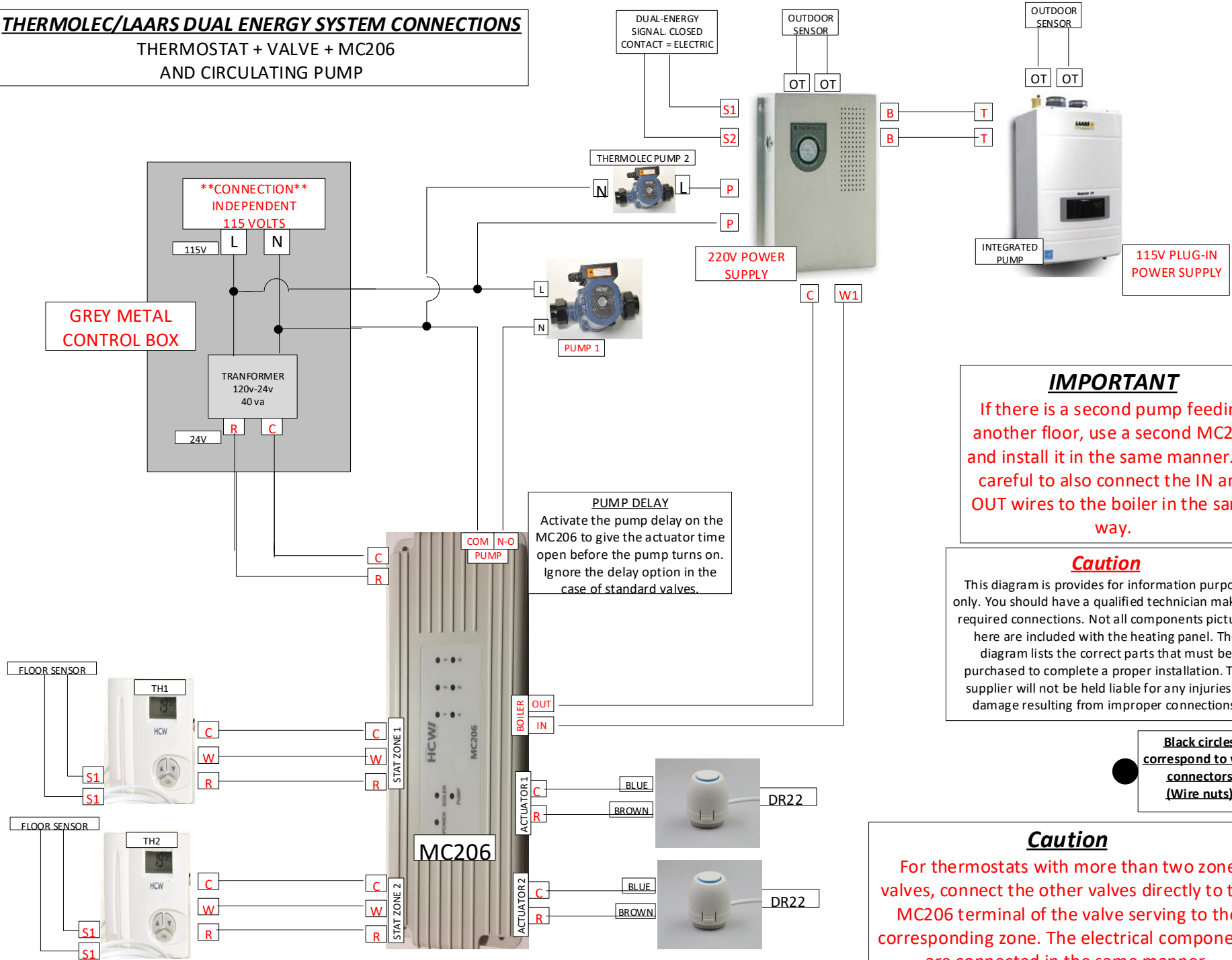

**IMPORTANT**  
If there is a second pump feeding another floor, use a second MC206 and install it in the same manner. Be careful to also connect the IN and OUT wires to the boiler in the same way.

**Caution**  
This diagram is provided for information purpose only. You should have a qualified technician make all required connections. Not all components pictured here are included with the heating panel. The diagram lists the correct parts that must be purchased to complete a proper installation. The supplier will not be held liable for any injuries or damage resulting from improper connections.

Black circles correspond to wire connectors (Wire nuts)

**Caution**  
For thermostats with more than two zone valves, connect the other valves directly to the MC206 terminal of the valve serving to the corresponding zone. The electrical components are connected in the same manner.